

RCF GENERAL NOTES

- 1-HOUR WALLS, TO DECK
- 1-HOUR WALLS, TO CEILING
- 2-HOUR WALLS, TO DECK
- ▨ INDICATES 1-HOUR STYBOD DECK @ 9'-0"
- ▨ INDICATES EXTENTS OF 1-HOUR SAT

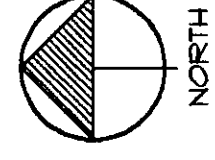

THIS RECORD DRAWING HAS BEEN PREPARED, IN PART, BASED UPON INFORMATION PROVIDED BY OTHERS. WHILE THIS INFORMATION IS BELIEVED TO BE CORRECT, THE DESIGN PROFESSIONAL CANNOT ASSURE ITS ACCURACY, AND THIS DRAWING IS NOT TO BE USED FOR ANY ERRORS OR OMISSIONS INCURRED BY THIS RECORD DRAWING. INCORPORATED INTO IT AS A RECORD DOCUMENT ARE ADVISED TO OBTAIN INDEPENDENT VERIFICATION OF THE INFORMATION BEING RELYED UPON FOR ANY PURPOSES.

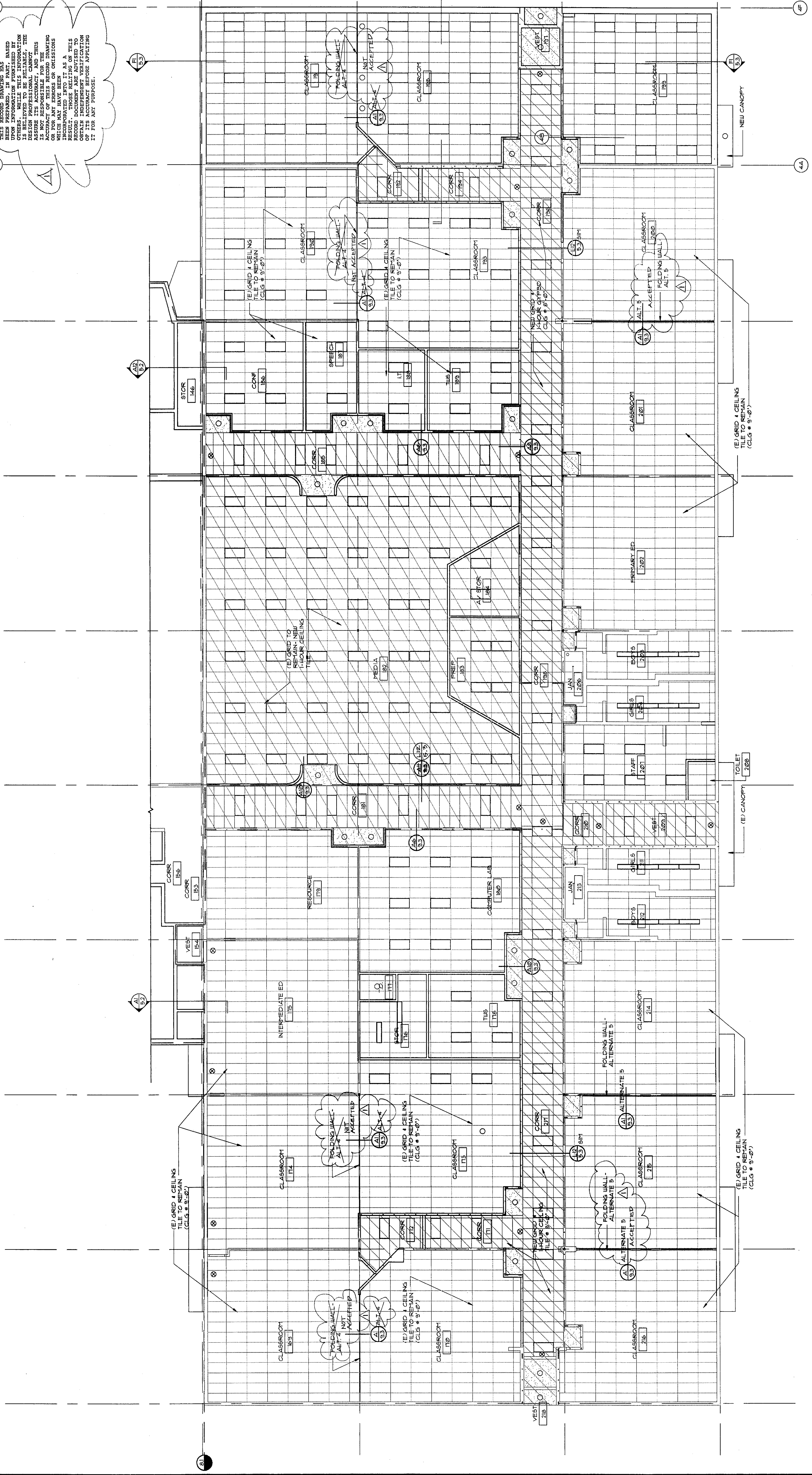

POUDRE SCHOOL DISTRICT R-1
 ADDITION & REMODEL
 FT. COLLINS, COLORADO

DESIGNER: Bremer and Bremer, Inc.
 222 S. Bremer, Fort Collins, CO 80521

JOB NUMBER	9113
DRAWN	KYH-KGL
CHECKED	GAB
ISSUE	12/27/22
REVISIONS	AA-BUILTS
SHEET NAME	SOUTH POD - REFLECTED CEILING PLAN
SHEET NUMBER	